

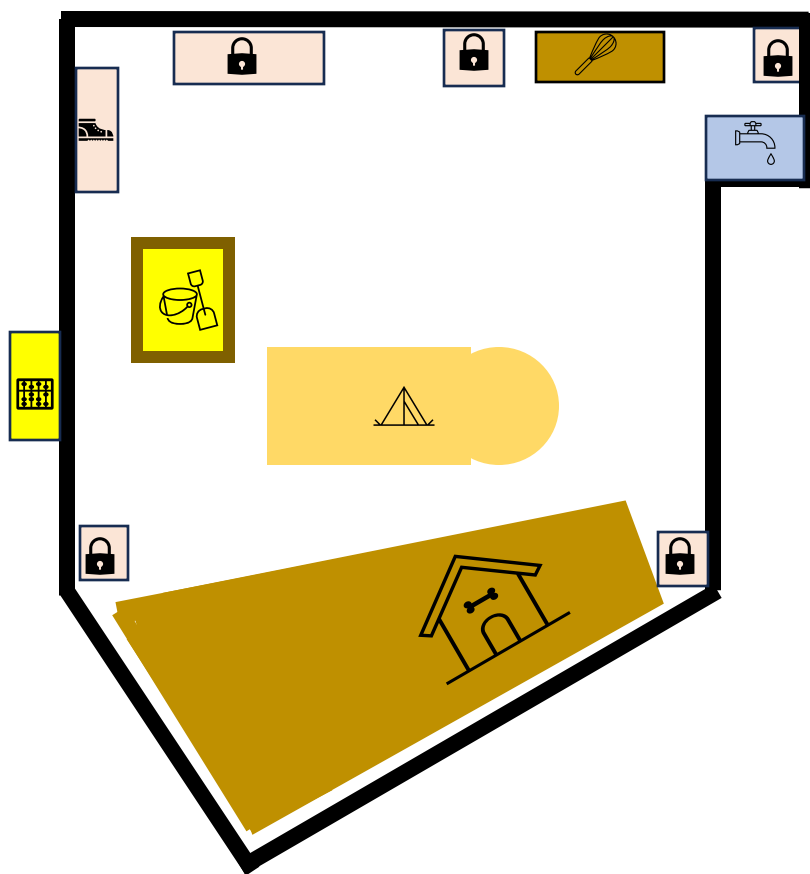









# Bradway Primary School Quotation

These quotations have been designed with due consideration to the needs of the students and teachers, accessibility and inclusion, the playwork principles, the forest school ethos and the environment where they will be housed.



Play Structure	Pages
1. Sensory Boards 	2
2. Storage Areas  	3
3. Sand pit 	4
4. Den building area 	5
5. The Storage Hut 	6
7. The Mud Station 	7
8. The Waterwall 	8



# 1. Sensory Boards

Cost

£780 + VAT

Installation of three bright and stimulating multi-sensory wall art boards (one frame at 1.2m x 1.2m and two frames at 1.2m x 0.6m). Crafted using marine ply with a stained timber surround and a wide range of natural multi-sensory items, which are suitable for outdoors.





## 2. Storage Areas and Welly Wall

Creating a series of bespoke storage compartments which are purpose built for the space and storage compartments, to include:

- Four single storage cupboards, three at 1.2m x 1.2m x 0.6m and one at 0.8m x 1.2m x 0.6m
- One double storage cupboard at 2.4m X 1.2m X 0.6m
- Each unit will have three shelves.
- One welly storage area. 2.4m x 0.7m x 0.6m (to hold 60 pairs).

All storage areas will be made with a sturdy frame, shiplap cladding and include slide bolts which can have a padlock inserted if needed.

*The images provided are not of our previous builds, but they represent the style and quality of what we will deliver.*



**Storage Areas & Welly Wall**

**£2,545 + VAT**

### 3. The Sand Pit

#### A 2m x 2m Sturdy Sandpit with Cover, Including:

- A solid, three-layered sandpit constructed from railway sleepers, finished with a robust 10x2 inch timber surround—ideal for seating and tinkering.
- An access step for easy entry and exit.
- A lightweight cover made from Shiplap cladding, complete with handles for easy lifting.
- Fully lined and filled with two tonnes of play-grade sand.
- Price includes removal of old sandpit



Example of a Play to Measure Sandpit

**Sandpit and Cover**

**£1,650 + VAT**





## 4. Den Building Area

**Construction of a den building area with shelving for toy storage, to include:**

- Installation of 5 upright rounded larch posts, each pre-drilled with holes to support den building.
- Creating a shelving area for accessible toy storage, 60cm wide x 60cm deep x 60cm high.
- Providing three unfixed tyres for storage of loose material
- Installation of larch posts to be co-ordinated to coincide with surfacing contractors.

**Den Building Area**

**£990 + VAT**





## 5. The Storage Hut:

**Development of a 2.2 x 1.5 metre storage shelter, including:**

- Sleeper upright posts, securely cemented into the ground
- Three fully clad walls constructed using loglap cladding
- Timber tongue and groove roof for durability and weather resistance
- Open entrance doorway
- 90cm x 60cm whiteboard mounted on the back wall



<b>The Storage Hut</b>	<b>£1,485 + VAT</b>
------------------------	---------------------





# Mud Station

A robust mud kitchen, measuring 2.4 meters in length and 1.2 meters at its tallest point. Features include:

- **Counter height customised** to suit the playground age group
- A **Belfast sink** with **taps**, **hobs**, a **chalk wall menu board**, an **oven**, a **cupboard**, and a **chopping board** for creative activities plus plenty of **shelving** and **hooks**.
- **Loglap backsplash**
- **A sleeper planter for storage of mud**, measuring 60cm width x 60cm depth x 40cm height

Built with sturdy framework, loglap cladding and chunky timber worktops

**Mud Station**

**£1,400 + VAT**

Examples of similar Play to Measure developments





**Examples of water walls built by Play to Measure**



## 7. Waterfall Wall

**Creation of an interactive water play wall on the brick wall of the outhouse, including:**

- Installation of four decorative timber battens fixed to the wall using masonry screws
- A series of dynamic water channels constructed from a mix of materials, such as plastic guttering, bamboo shoots transparent water pipes and funnels
- A variety of attachments to allow children to control, redirect, and experiment with the flow of water
- A basin at the base of the wall to collect water from the runs
- A basin to collect water at the end of the water runs.

**Waterfall Wall**

**£1,350 + VAT**





**Quotation for:** Bradway Primary School

**Quotation date:** 17/06/2025

**Quotation details:** This quotation incorporates all the installations and specifications listed above and is valid for 30 days.

**CUSTOMER RESPONSIBILITIES:** It will be the responsibility of the customer to ensure, in writing, that they have obtained any necessary consent or planning permission for the installation to commence. Play to Measure will not be responsible for any damages or loss to the customer caused by any failure to obtain such consents.

**SUPERVISED SPACES FOR CHILDREN:** Play to Measure design and build structures for supervised spaces only.

**WASTE:** Play to Measure are unable to remove any waste that originated from your property arising from the installation of works. You may have to pay for hire of a skip if you do not have alternative disposal arrangements.

**INSTALLATION:** This is a fixed price quotation based upon an estimated fitting time. If the fitting takes a longer or shorter duration, the price will remain as quoted.

**LOSS OR DAMAGE OF STRUCTURE OR MATERIALS ON CUSTOMER'S PROPERTY:** Timber and other heavy materials will be delivered directly to your property from the suppliers and will remain there throughout the period of your project's construction. Play to Measure cannot be held responsible for the loss or damage to the structure or materials on your property including theft or vandalism.

**VAT:** Play to Measure are VAT registered. VAT Number: 402 1924 40

**PAYMENT ACCEPTED VIA BACS:** 50% deposit payable upon confirmation of installation date. Final balance payment of 50% due upon completion. Payment of deposit shall be deemed as acceptance of the above terms.



[www.playtomeasure.co.uk](http://www.playtomeasure.co.uk)

TEL: 07810 585 313

[info@playtomeasure.co.uk](mailto:info@playtomeasure.co.uk)







“We couldn’t be happier with our custom-made creation from Play to Measure! It wasn’t an easy ask but Play to Measure designed it exactly as we’d hoped for, putting the needs and safety of our children above everything else.”

**Natalie Babb, Teacher at Brockmoor Specialist Nursery, Brierley Hill**







## Transforming Indoor Learning Spaces





"From the initial meeting it was clear that Keith's creative vision was something that the students at Penn Fields School would really benefit from. The enthusiasm, craftsmanship and attention to detail have been superb. Play to Measure have been so accommodating, fully engaging with students and staff to bring their vision into reality. Keith and the team have transformed our woodland area into a truly magical space where our students can explore and play in a safe environment."

**Mary Evans, School Business Manager**



"Play to Measure offered a creative solution to our requirements for Forest School at Wollescote Primary. The team worked tirelessly to create a beautiful yet practical environment in our new forest school site and developed playful links to our old forest school site. Through regular communication and creative thinking, the space has developed organically into a fantastic child focused area for outdoor learning. I would highly recommend them."

**Adam Edwards, Site Manager at Wollescote Primary School (Stourbridge)**



"Working with Play to Measure has been a really positive experience for Pens Meadow. The students and staff have been fully involved in the design and build itself where possible. The Play to Measure team are more than creative, they are ingenious, in designing challenging, adventurous, safe environments that have enhanced the provision we can offer our pupils in our Forest School beyond our expectations. I would recommend Play to Measure without hesitation."

— **Marie Hunter, Headteacher at Pens Meadow School**







"I've had the pleasure of watching the Play to Measure project develop and witnessing the staff and students' response to their new area – They were blown away!"

**Lisa Pearce, TLSA English  
at Penn Fields School**

